



PHOENIKS

ELECTRIC SURFACE INDUCTION RANGE 2 CROSSWISE

OPTIMA 700

MODEL NO: 10013249

Product Advantages:

- Housing made completely of stainless steel.
- Visible surfaces with polished and stain finish, 320 grit.
- Tightly welded top plate with lateral drain channels for easy cleaning.
- Ceramic hob 305 x 540 mm.
- Hob with two heating zones, 3.5 kW each.
- Cooking zones 200 mm in diameter.
- Electronic pan size recognition as standard.
- PT 1000 protection against overheating.

Installation requirements:

- Electrical supply provided by customer.

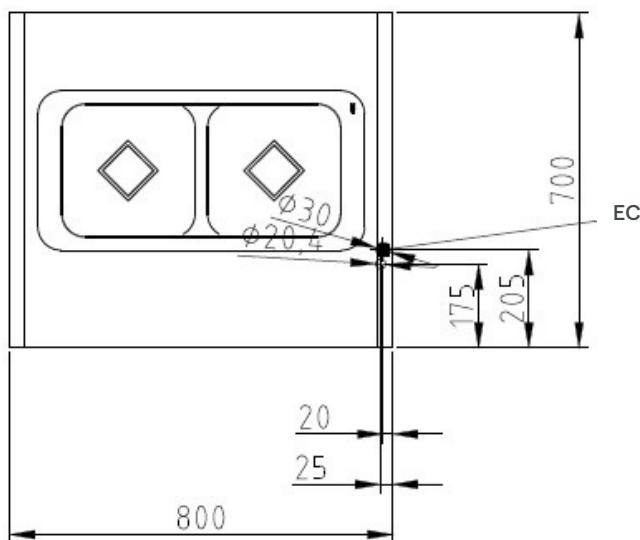
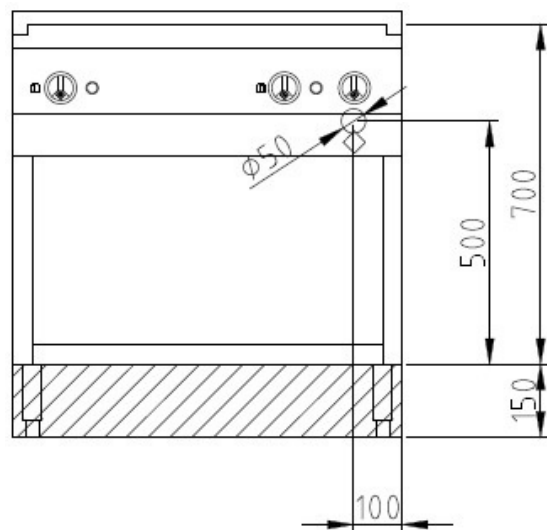

Technical Data:

Width x Height x Depth (mm)	800 x 700 (900) x 700
Effective area	2
Dim.: effect. Area (mm)	690 x 340
Connected load per zone (kW):	5.0
Connected load (elect.) (kW):	10.0
Voltage (V) / EC:	415 3 phase AC
Recommended fuses (A):	3 x 16
Type of protection:	IPX5



phoeniks.com.au

P- 1300 405 404

E- contact@phoeniks.com.au