



PHOENIKS

ELECTRIC GRIDDLE PLATE 2 SUPRA

OPTIMA 700

MODEL NO: 2121130A

Product Advantages:

- Housing made completely of stainless steel.
- Tightly welded top plate with lateral drain channels for easy cleaning.
- SUPRA heating system-contact heating elements integrated into aluminium blocks ensure greater heating capacity and even heat distribution, shorter heating up times and a longer service life of heating elements.
- Smoothly polished frying surface made of PowerBlock special sandwich material
- Appliance with two separate heating zones.
- Steel frying surface 700 x 540 mm.
- Fat collecting container approx. 4 litres.
- Supplied ready for connection to a power optimising system.

Installation requirements:

- Electrical supply provided by customer.

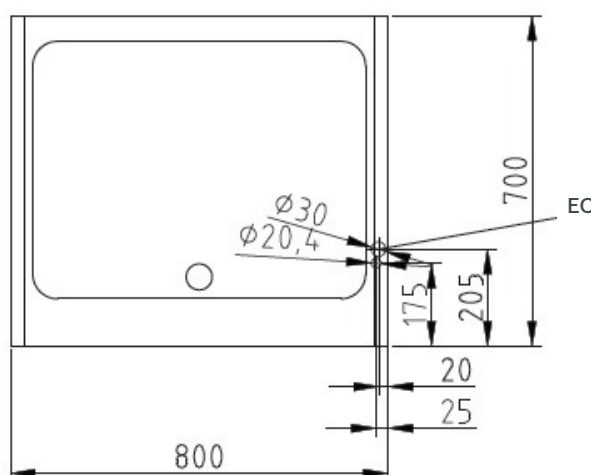
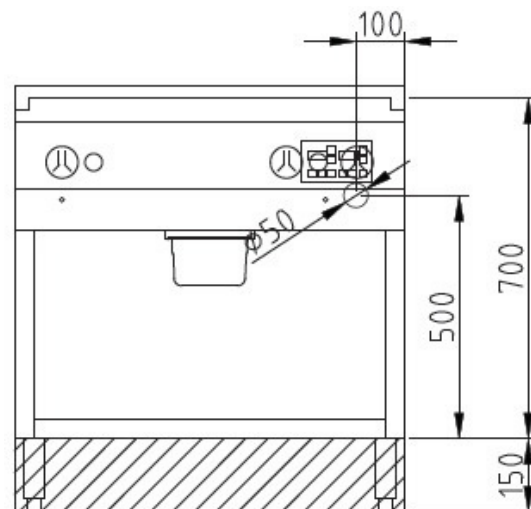

Technical Data:

Width x Height x Depth (mm)	800 x 700 (900) x 700
Effective area	1
Dim.: effect. Area (mm)	700 x 540
Connected load (elect.) (kW):	10.8
Voltage (V) / EC:	415 3 phase AC
Recommended fuses (A):	3 x 20
Net weight (kg):	95
Gross weight (kg):	104
Heat emission latent (W):	4320
Heat emission sensitive (W):	3564
Type of protection:	IPX5



phoeniks.com.au

P- 1300 405 404

E- contact@phoeniks.com.au