



Product Advantages:

- Housing made completely of stainless steel.
- Appliance height only 270mm; more space in substructure.
- U-shaped connection channel, flush with top plate; tightly fitted to the substructure, for maximum hygiene.
- Directed drainage of fluids via a drip outlet in the top plate at the front.
- Smoothly polished frying surface made of PowerBlock special sandwich material.
- Appliance with two separate heating zones.
- Steel frying surface 440 x 560 mm.

Product Advantages:

- Electrical supply provided by customer.

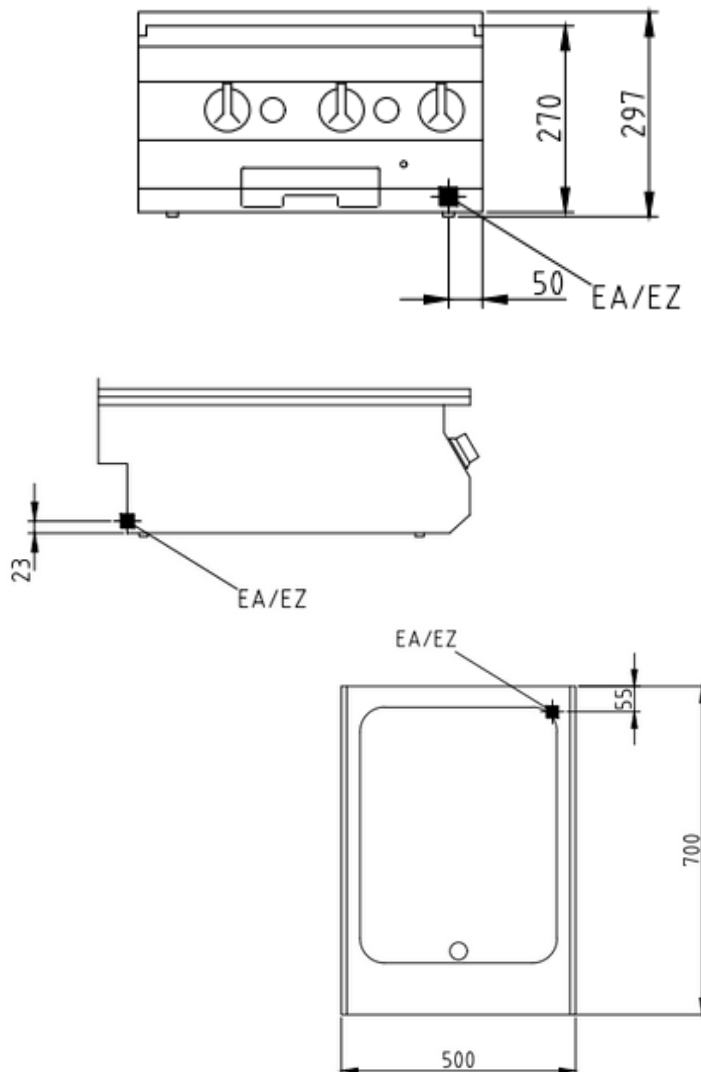

Technical Data:

Reference:	1221135A
Width x Height x Depth (mm)	500 x 270 x 700
Dim. effect. Area (mm)	440 x 560
Connected load (elect.) (kW):	7.2
Voltage (V) / EC:	415 3 phase AC
Recommended fuses (A):	3 x 20
Net weight (kg):	52
Gross weight (kg):	60
Heat emission latent (W):	2880
Heat emission sensitive (W):	2376
Type of protection:	IPX4

