

FlexiChef®– Outstanding productivity and excellent food quality.

Product Advantages:

- MaxPower and FlexPower variants available
- MagicPilot – Robust, wear-free, capacitive true colour touch screen.
- AutoChef – Automatic cooking in 10 cooking categories from Meat to Perfection (regeneration)
- Manual operation – Allow you the freedom to prepare a wide variety of dishes according to your own wishes and requirements.
- Turbo PowerBlock – Pan bottoms with intelligent heating system (energy saving and efficient).
- SpaceClean (Option) – automatic cleaning system for skillet pans and lids.
- ReadyXpress (Option) – High speed in the production process.
- FlexiZone - Simultaneous frying on up to 3 zones
- OpenXpress (Option) – Pressure reduction is possible in at least one minute.
- Integrated Hand Shower (Option)
- Automatic filling and emptying.
- Automatic lid opening and closing.
- Option of control panel on left or right side.

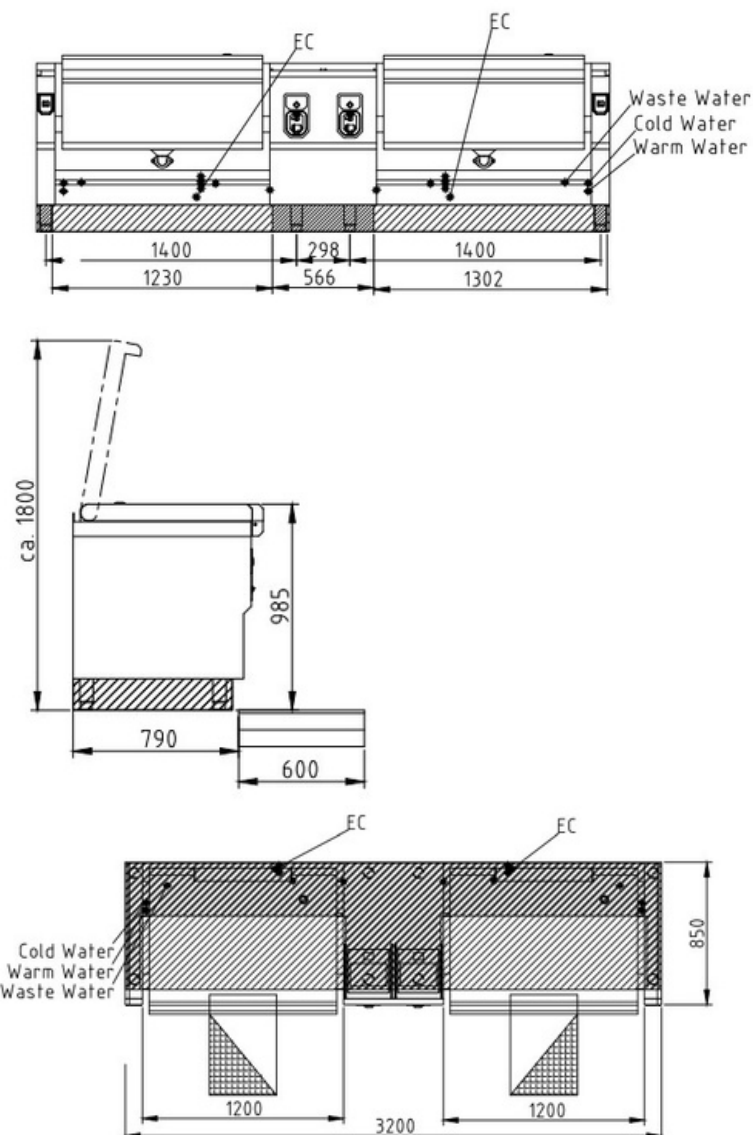

Technical Data:

Width x Height x Depth (mm)	3200 x 750 x 850
Usable capacity (L)	100 + 100
Max Oil Capacity (L)	49 + 49
Weight (kg)	780 (with Options)
Electric Load (MaxPower) (kW)	36.7 + 36.7
Recommended fuses (MaxPower) (A)	3 x 64 + 3 x 64
Electric Load (FlexPower) (kW)	28.2 + 28.2
Recommended fuses (FlexPower) (A)	3 x 50 + 3 x 50
Voltage (V) / EC:	415 3 phase AC
Type of protection:	IPX 6

