

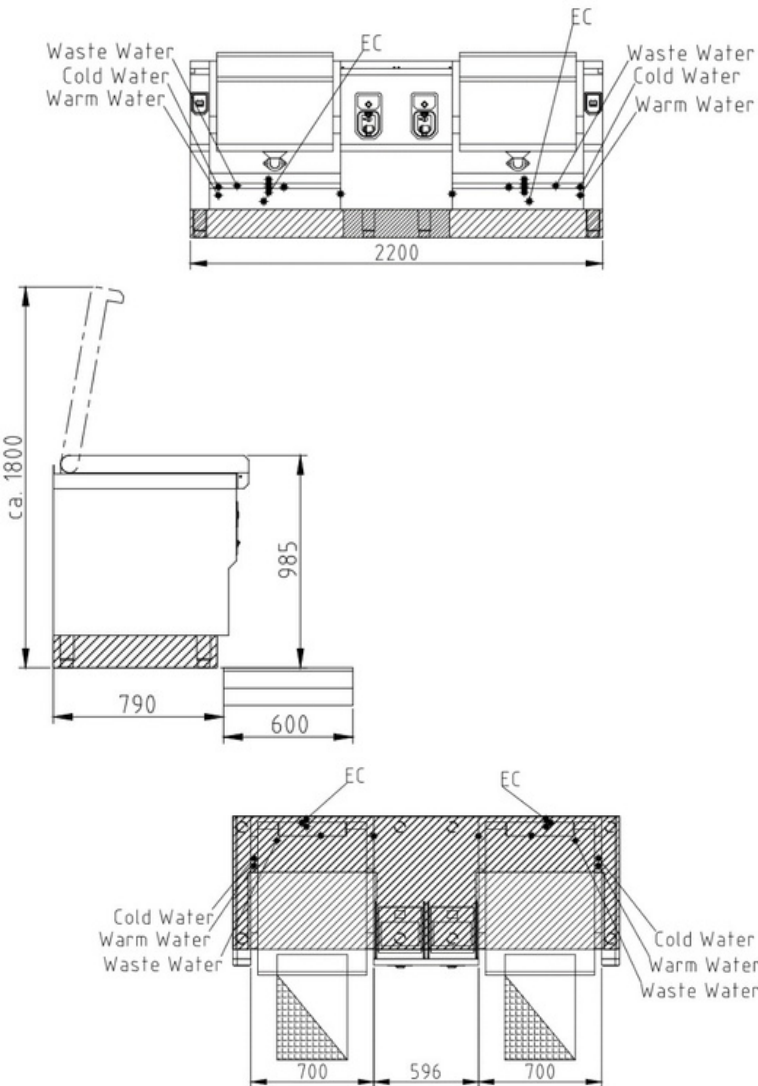

FlexiChef ® – Outstanding productivity and excellent food quality.

Product Advantages:

- MaxPower and FlexPower variants available
- MagicPilot – Robust, wear-free, capacitive true colour touch screen.
- AutoChef – Automatic cooking in 10 cooking categories from Meat to Perfection (regeneration)
- Manual operation – Allow you the freedom to prepare a wide variety of dishes according to your own wishes and requirements.
- Turbo PowerBlock – Pan bottoms with intelligent heating system (energy saving and efficient).
- SpaceClean (Option) – automatic cleaning system for skillet pans and lids.
- ReadyXpress (Option) – High speed in the production process.
- FlexiZone - Simultaneous frying on up to 3 zones
- OpenXpress (Option) – Pressure reduction is possible in at least one minute.
- Integrated Hand Shower (Option)
- Automatic filling and emptying.
- Automatic lid opening and closing.
- Option of control panel on left or right side.



Technical Data:

Width x Height x Depth (mm)	2200 x 750 x 850
Effective area/volume (mm)	523 x 225 x 543
Usable capacity (L)	50 + 50
Max Oil Capacity (L)	25 + 25
Weight (kg)	580 (with Options)
Electric Load (MaxPower) (kW)	15.8 + 15.8
Recommended fuses (MaxPower) (A)	3 x 32 + 3 x 32
Electric Load (FlexPower) (kW)	13.9 + 13.9
Recommended fuses (FlexPower) (A)	3 x 25 + 3 x 25
Voltage (V) / EC:	415 3 phase AC
Type of protection:	IPX 6

